

# PS Business Parks

RETAIL, OFFICE AND INDUSTRIAL SPACE AVAILABLE • 1833 WEST MAIN STREET • MESA, ARIZONA



## FEATURES:

- ±78,038 square foot project
- One mile east of Loop 101 Freeway
- Adjacent to Valley Metro rail stop
- Great East Valley location
- 2.7–3.3/1,000 parking ratio
- Monument signage available
- Office, warehouse and retail spaces available

## DEMOGRAPHIC PROFILE:

- Traffic Counts:  
Dobson Road (N/S).....26,000 / 30,000 vpd  
Main Street (W) .....26,000 vpd  
Source: MAG 2007
- Population:
 

	1 mi radius	3 mi radius	5 mi radius
Est. Population (2008)	22,238	144,398	364,652
Proj. Population (2013)	23,878	154,287	386,342
- Average Household Income:  
Est. Avg. HH Income (2008) \$46,579 \$49,514 \$59,392
- Median Household Income:  
Est. Med. HH Income (2008) \$43,609 \$44,779 \$53,065

## MAP / LOCATION:

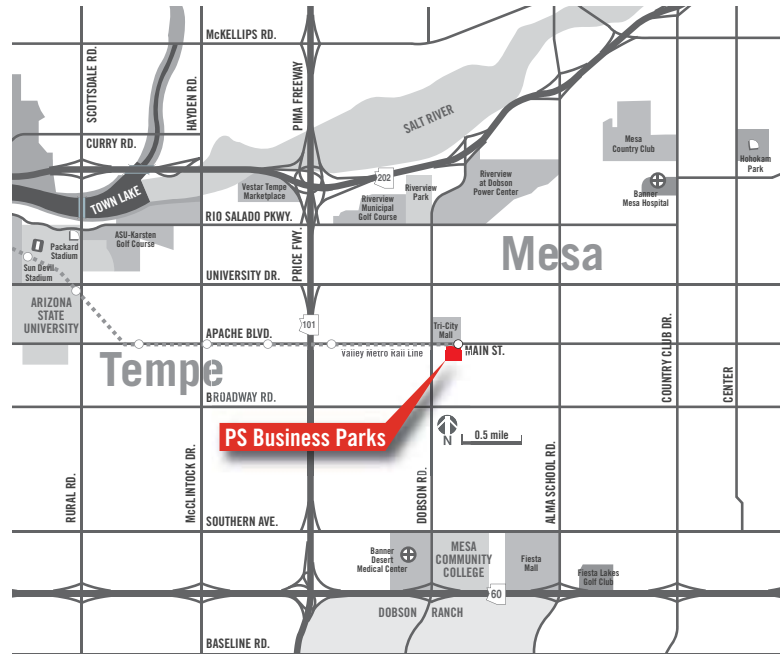

**PSBUSINESSPARKS**

www.psbusinessparks.com  
Leasing Office: (602) 997-6332

## FOR LEASING CONTACT:

**MARC PIERCE**  
(602) 954-3750 direct • (602) 697-2922 mobile  
mpierce@lee-associates.com

**MATT FREDRICK**  
(602) 912-3532 direct • (602) 373-6922 mobile  
mfredrick@lee-associates.com

**DAVID LANE**  
(602) 474-9562 direct • (602) 723-0004 mobile  
dlane@lee-associates.com



# PS Business Parks

RETAIL, OFFICE AND INDUSTRIAL SPACE AVAILABLE • 1833 WEST MAIN STREET • MESA, ARIZONA

## SITE PLAN:

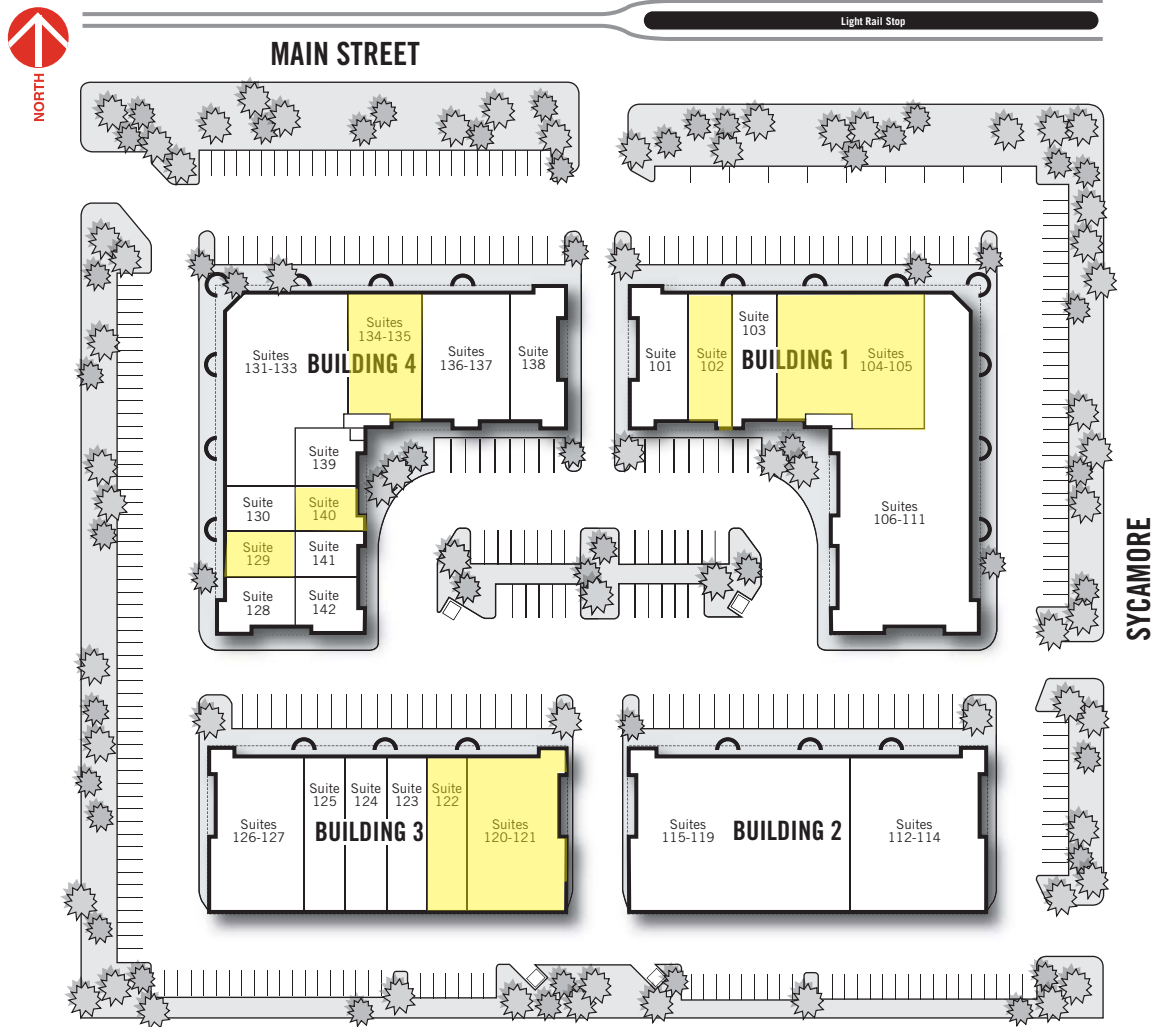

 available

All information furnished regarding property for sale, rental or financing is from sources deemed reliable, but no warranty or representation is made to the accuracy thereof and same is submitted subject to errors, omissions, change of price, rental or other conditions prior to sale, lease or financing or withdrawal without notice. No liability of any kind is to be imposed on the broker herein.



**PSBUSINESSPARKS**

www.psbusinessparks.com  
Leasing Office: (602) 997-6332

## FOR LEASING CONTACT:



**MARC PIERCE**  
(602) 954-3750 direct • (602) 697-2922 mobile  
mpierce@lee-associates.com  
**MATT FREDRICK**  
(602) 912-3532 direct • (602) 373-6922 mobile  
mfredrick@lee-associates.com  
**DAVID LANE**  
(602) 474-9562 direct • (602) 723-0004 mobile  
dlane@lee-associates.com